

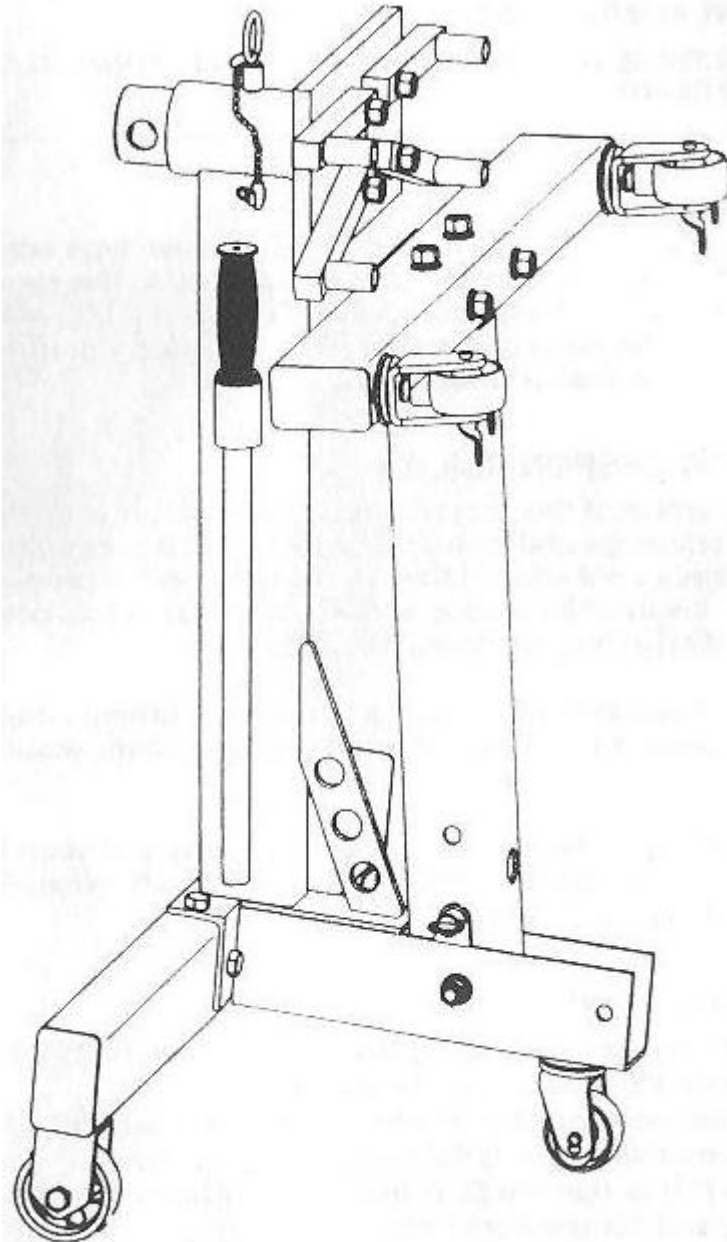

OWNER'S MANUAL
FOLDING ENGINE STAND
1,500 lb capacity





 **WARNING** 

- STUDY AND UNDERSTAND AND FOLLOW ALL WARNINGS AND INSTRUCTIONS BEFORE USING THIS STAND
- DO NOT EXCEED RATED CAPACITY
- USE ONLY ON HARD, LEVEL SURFACES CAPABLE OF SUSTAINING A FULL CAPACITY LOAD.
- LOCK MOUNTING PLATE ROTATING MECHANISM BEFORE APPLYING LOAD
- BE SURE ENGINE IS CENTERED AND SECURED TO MOUNTING PLATE BEFORE APPLYING LOAD TO STAND
- OFF CENTER LOADS MAY MAKE THE LOAD AND HANDLE ROTATE IN EITHER DIRECTION WHEN THE ROTATIONAL LOCKING DEVICE IS RELEASED
- RELEASE THE ROTATIONAL LOCKING DEVICE SLOWLY AND CAREFULLY
- DO NOT ATTEMPT TO MOVE THE LOADED STAND ACROSS A FLOOR HAVING CRACKS OR OTHER OBSTACLES THAT COULD IMPEDE MOVEMENT
- NEVER WORK DIRECTLY UNDER A SUPPORTED LOAD
- VISUALLY INSPECT STAND FOR DAMAGE BEFORE USE. CHECK FOR CRACKED WELDS, BENT METAL AND LOOSE, DAMAGED OR MISSING PARTS.
- USE ONLY GOODYEAR RACING OR ALLIED QUALITY ATTACHMENTS AND ADAPTERS
- DO NOT MAKE ANY ALTERATIONS TO THIS PRODUCTS
- FAILURE TO HEED THESE WARNINGS MAY RESULT IN PERSONAL INJURY, PROPERTY DAMAGE AND/OR DEATH.

DESCRIPTION:

This engine stand is a device used to mount an automotive type engine when removed from a vehicle. This device is designed to provide access to the engine for servicing and/or rebuilding. The stand incorporates a locking, rotating Mounting Plate so that the user can turn the engine for ease of access. The stand also incorporates wheels and castors to allow mobility across a smooth, flat surface.

Owner/Operator RESPONSIBILITY:

The owner and/or operator of this product must have a complete understanding of all warnings and instructions including inspection and maintenance procedures contained in this manual and on the product label before using this product. Anyone involved in the use and/or operation of this device must be careful, competent, and qualified in its safe operation and use.

If the operator is not fluent in English, instructions and warnings must be read to and discussed with the operator in the operator's native language, ensuring comprehension and understanding.

It is also the responsibility of the owner/operator to study and keep this manual and all product and warning labels intact and legible for further reference. Replacement labels and manual are available upon request.

ASSEMBLY INSTRUCTIONS:

1. Assemble mast (1) to rear leg (2) using the bolts (5), two bolts (6) and nuts (7) and lock washer (8) and flat washers (9) as shown.
2. Assemble the cross member (3) to the front leg using two bolts (5), two bolts (6) and nuts (7), lock washers (8) and flat washers (9) as shown.
3. Assemble wheels (14) to rear leg (2) using shoulder bolts (15) and nuts (16), lock washers (17) and flat washers (18) as shown.
4. Mount the middle caster (22) to the mast assembly (1) using nut (20) and lock washer (21) as shown.
5. Assemble locking casters (19) to front leg (4) using nuts (20) and lock washers (21).
6. Assemble crossmember assembly (3,4) to the mast assembly (1) using the shoulder bolt (10) and nut (11), lock washer (12) and flat washer (13) as shown.
7. Insert head (25) into housing at top of mast (1). Fasten using the locking pin (28).
8. Assemble mounting adaptors to the head using bolts (27) and nuts (7) lock washer (8) and flat washers (9) as shown.
9. Tighten all fasteners and place caps (32) into the leg ends as shown.

- These specifications are subject to change without notice

NOTE: All fasteners are Metric. English approximate (inch) equivalents are given for reference only.

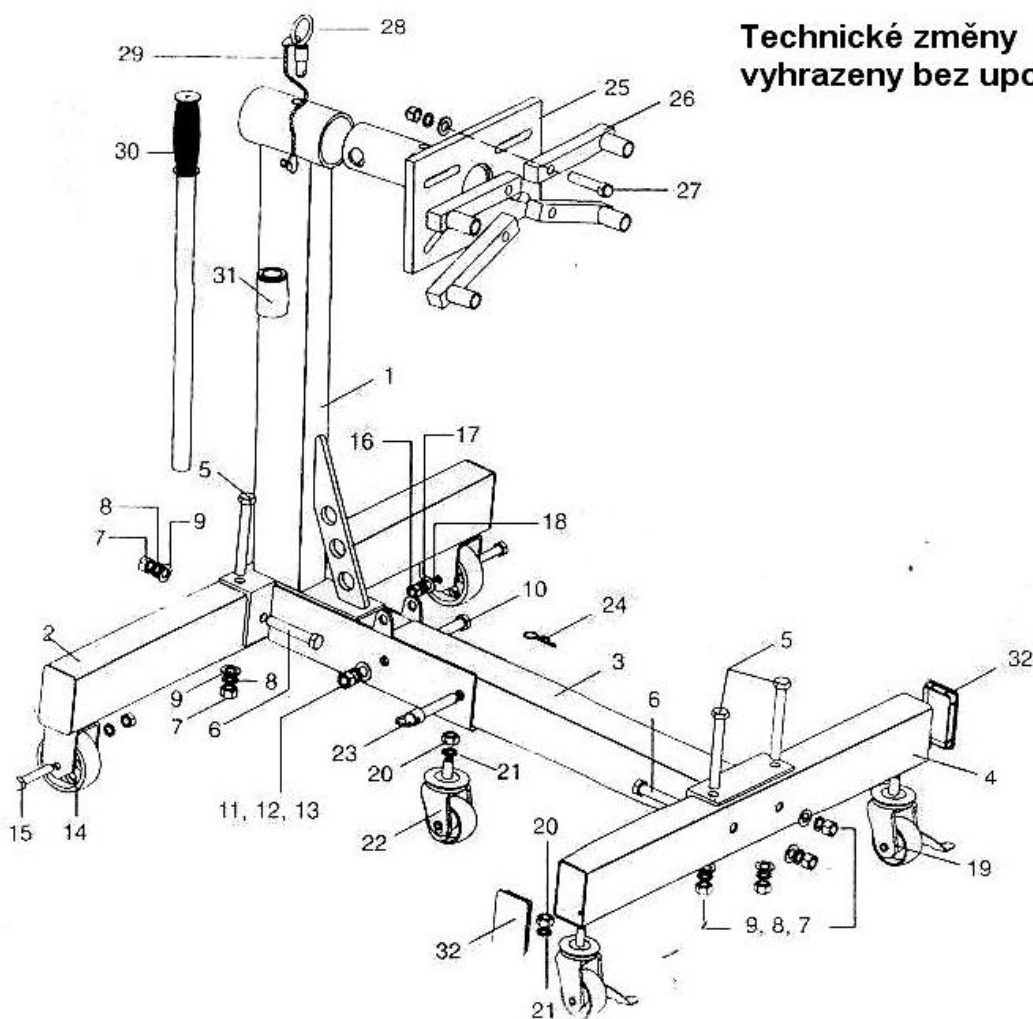

**Technické změny
vyhrazeny bez upozornění**

Všechny rozměry jsou metrické míře. Palcové údaje jsou pouze orientační.

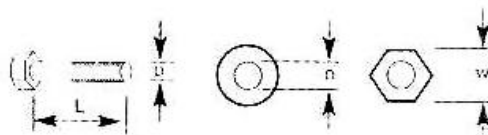

Nr	Description	Q	Nr	Description	Q
1	Mast assembly	1	17	Lock washer 8 mm	2
2	Rest leg	1	18	Flat washer 8 mm	2
3	Cross member	1	19	Locking caster	2
4	Front leg	1	20	Nut	3
5	Bolt 12 x 100 mm (1/2" x 4")	4	21	Lock washer	3
6	Bolt 12 x 75 mm (1/2" x 2 3/4")	4	22	Caster	1
7	Nut 17 mm	12	23	Pin	1
8	Lock washer 12 mm	12	24	Spring clip	1
9	Flat washer 12 mm	12	25	Mounting head	1
10	Bolt 12 mm (1/2" x 3")	1	26	Mounting adapter	4
11	Nut 18 mm	1	27	Bolt 12 x 50 mm (1/2" x 2")	4
12	Lock washer 10 mm (3/8")	1	28	Head locking pin	1
13	Flat washer 10 mm (3/8")	1	29	Chain	1
14	Wheel	2	30	Handle	1
15	Bolt 10 mm x 60mm(3/8" x 2-3/8")	2	31	Grommet	1
16	Nut 14 mm	2	32	Cap	4

OPERATION:

Before applying load, lock mounting plate rotating mechanism. Using a hoist, suspended the engine at a level with the mounting plate. With the mounting arms loose from the mounting plate (but not removed) bolt the mounting arms to the rear of the engine using the bell housing mounting bolts (bolts not supplied. make sure the engine is centered and straight on the mounting plate, then tighten the mounting arms to the engine, and the mounting arms to the mounting plate. After making sure all connections are tight, SLOWLY lower the hoist, transferring load to the stand. To remove an engine from the stand, first attach the hoist to the engine using a sling or similar device. After the hoist and sling are secure to the engine, raise the hoist, taking the load off of the stand. The mounting bolts can be removed freeing the stand from the engine.

INSPECTION:

A complete visual inspection must be made before each use of the stand. Check for broken or cracked welds, excessive rust, and loose, damage or missing parts. Check that the wheels and casters operate smoothly. Also check that the mounting plate rotation lock works properly before applying load. If any problems as described above or otherwise are found, remove the stand from service. Also inspect the label, making sure that it is legible, and securely attached to the stand. If not, call the Allied parts department for a replacement. If the stand has been, or is believed to have been subjected to an abnormal load or shock load, you must inspect the stand IMMEDIATELY, before putting the stand into or resuming service. If you are unsure about the condition of your stand, please call our Consumer Hotline listed below.

MAINTENANCE:

Keep your stand clean well lubricated. Lubricate all wheel axles with motor oil or light machine oil and grease the caster swivel bearings once a year or as necessary. Also apply a thin coat of crease to the mounting plate rotating mechanism as necessary, but at least once a year.

ZÁRUČNÍ LIST			
Název výrobku			
Typ výrobku			
Datum prodeje			
Razítko a podpis prodejce			
Záznam o provedeném servisním zákroku			
Datum převzetí servisem	Datum provedení opravy	Číslo reklamačního protokolu	Podpis pracovníka
Poznámky			

